

7

1.04

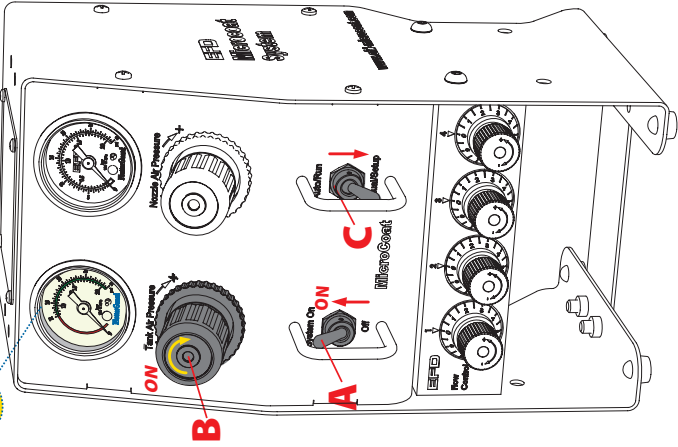

9

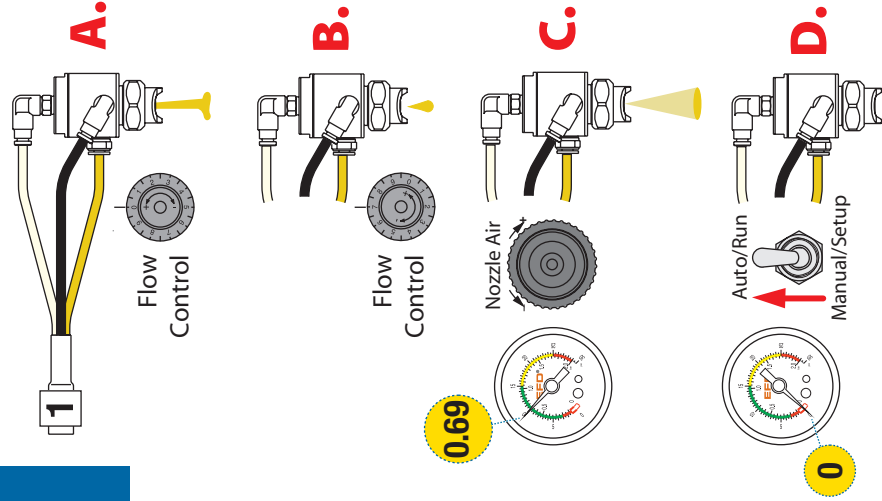

8

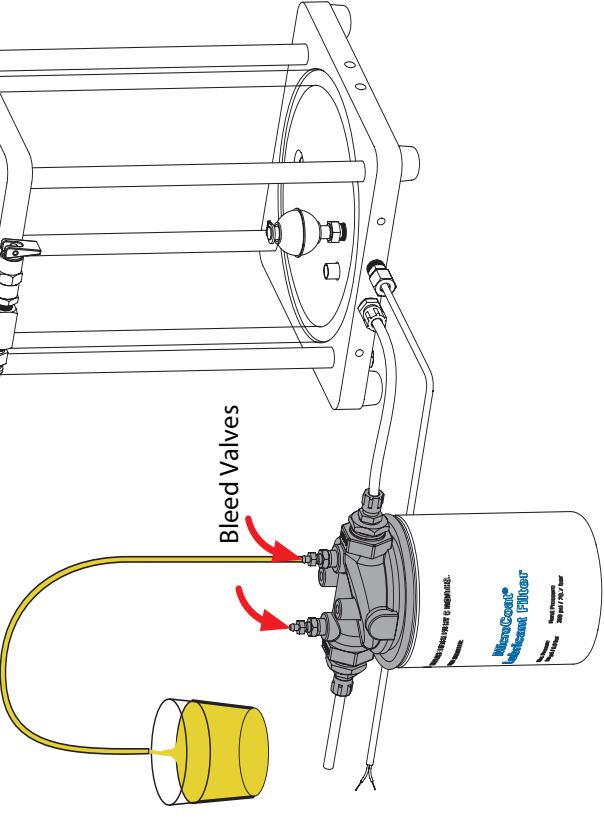

7

- A. System Pressure ON**
 - B. Tank Air Pressure to 1.04 bar (15 psi)**
 - C. Auto/Run to Manual/Setup**
- Clear the air from the lubricant filter. Insert tube into bleed valves. Open bleed valves one at a time 1/2 turn. Once fluid flows from the bleed valves, close.
- Prime each valve.
- A. Open each Flow Control five (5) full turns. When lubricant flows without any trace of air, close all Flow Controls.**
 - B. Adjust Flow Controls** so lubricant flows at about one drop per second. Use this setting as a starting point for all valves.
 - C. Turn Nozzle Air** until pressure reads 0.69 bar (10 psi). Higher pressure provides finer spray. Too much pressure causes fogging.
 - D. SWITCH to Auto/Run.** The valves stop spraying and the **Nozzle Air** pressure drops to 0 psi.
- The system is ready.**
When press is on, **Nozzle Air** pressure will return to 0.69 bar (10 psi), and valves will spray. Check lubricant coverage and make adjustments as necessary.

MC800 Series

MicroCoat® SETUP GUIDE

Configure your MC800 MicroCoat system with tank, stand and control solenoid.

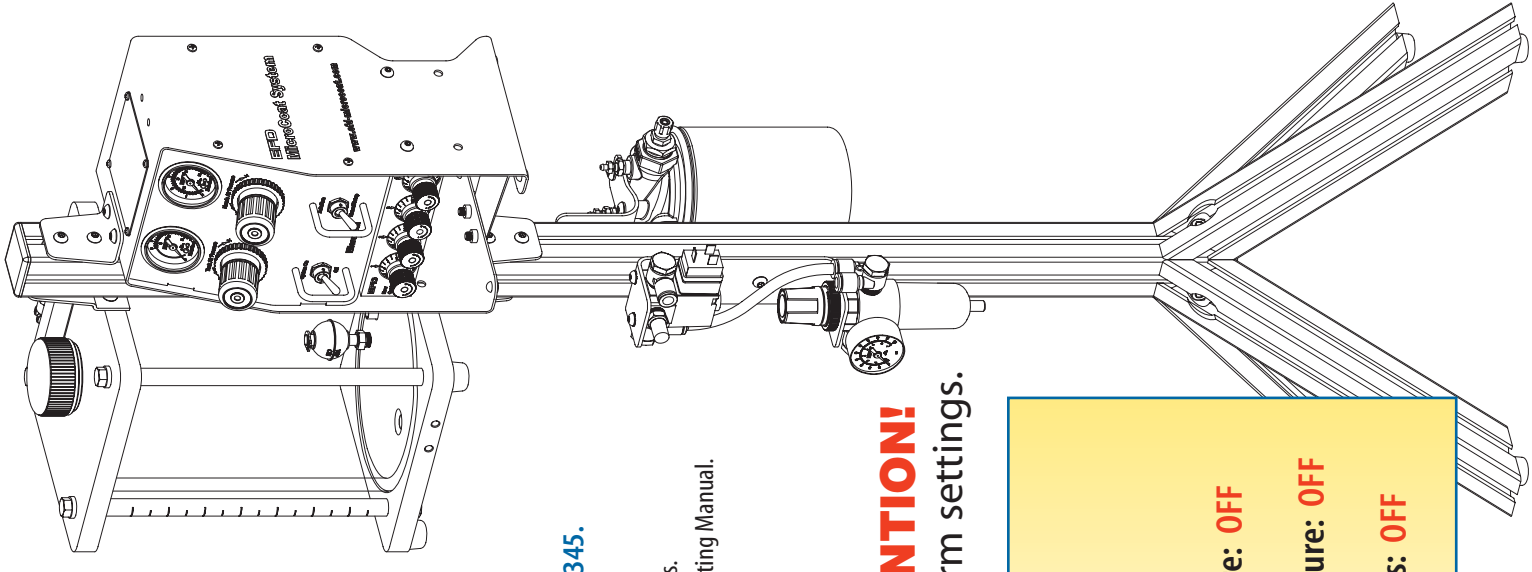

If trouble cannot be corrected, or if you need further assistance, please call us. In the US, call 800-556-3484. In the UK, phone 0800 585733. In Asia, +86 (21) 5854 2345. e-mail: microcoat@efd-inc.com www.efd-microcoat.com

Sales and service of the MicroCoat System are available worldwide through EFD authorized distributors. For detailed operating instructions and safety guidelines, please refer to your MicroCoat System Operating Manual.

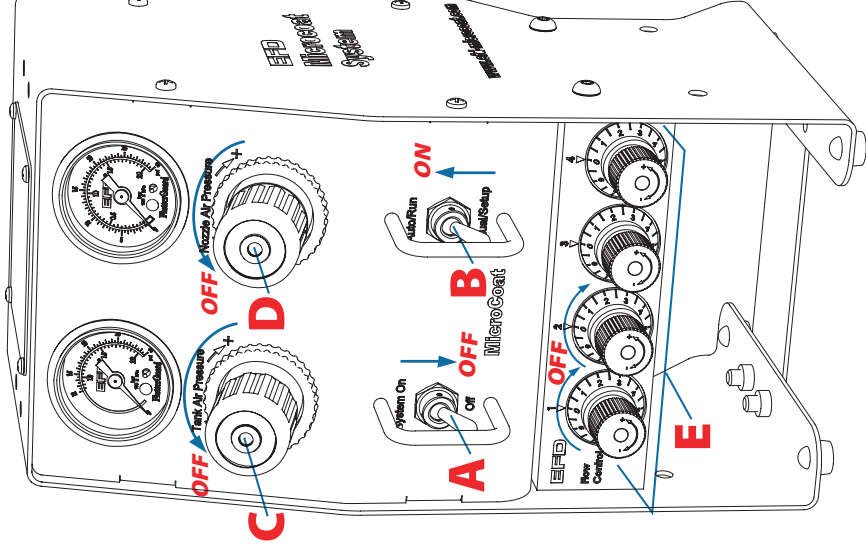

ATTENTION!
Confirm settings.

- A. System: OFF**
- B. Auto/Run: ON**
- C. Tank Air Pressure: OFF**
- D. Nozzle Air Pressure: OFF**
- E. All Flow Controls: OFF**

EFD
A NORBON COMPANY

USA: 800-556-3484 or +1-401-434-1680
Europe: 0800 585733 or +44 (0) 1582 666334
Asia: +86 (21) 5854 2345
microcoat@efd-inc.com www.efd-microcoat.com

1

Connect air filter regulator.
Set to 4-14 bar (60 psi).

2

Connect air solenoid to press run/clutch circuit.
Note: Solenoid included with pre-assembled systems.

3

Mount valves and manifolds. Connect color-coded hoses between controller, manifolds and valves.

4

Use valve alignment tool on valves to set distance from stock.

Note: MC785M—use yellow template.
MC785M-WF—use red template.

5

A. Connect reservoir and filter fluid lines to flow control inlet fitting.

6

Connect in series with Press Emergency Stop Circuit.
For dual tank installation, refer to your MicroCoat System Operating Manual.

B. Connect reservoir pressure hose to tank air outlet on controller.
C. Fill reservoir.

WIRING CHART FOR EFD SUPPLIED SOLENOIDS

Solenoid Wires	brown	blue	yellow	green
DC solenoid	negative (-)	positive (+)	ground (⇆)	ground (⇆)
AC solenoid	no polarity	no polarity	ground (⇆)	ground (⇆)



For EFD sales and service in over 30 countries, contact EFD or go to www.efd-microcoat.com/worldwide.html

EFD, Inc.
East Providence, RI USA
800-556-3484; +1-401-434-1680 (outside the USA)
microcoat@efd-inc.com www.efd-microcoat.com

EFD International Inc.
Dunstable, Bedfordshire, UK
0800 585733 or +44 (0) 1582 666334
Ireland 00800 8272 9444
europe@efd-inc.com www.efd-microcoat.com

EFD, Inc., Asia
China: +86 (21) 5854 2345
china@efd-inc.com www.efd-microcoat.com/cn
Singapore: +65 6896 9630 sin-mal@efd-inc.com

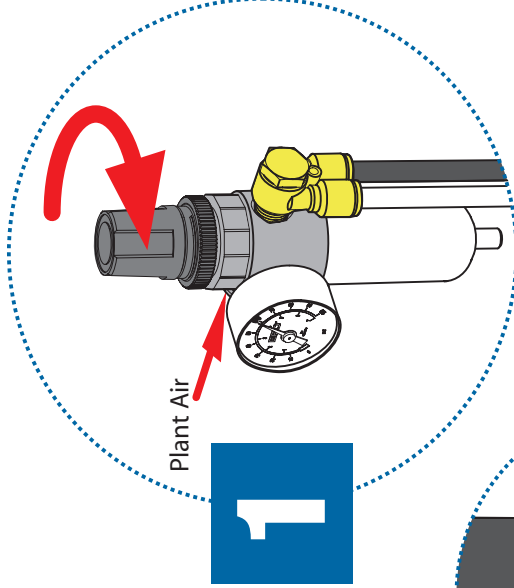

1

4

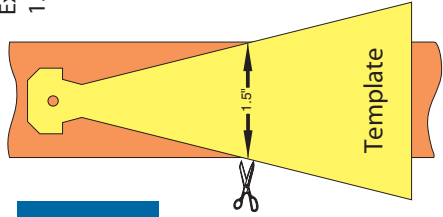

Example:
1.5" wide stock

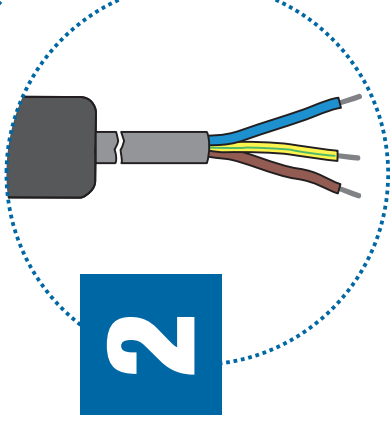
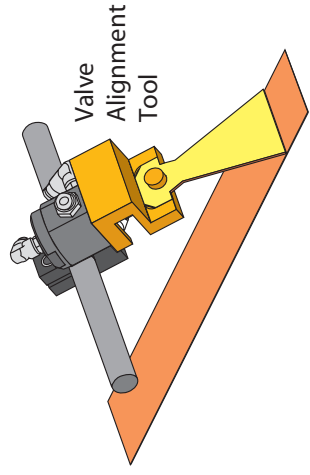
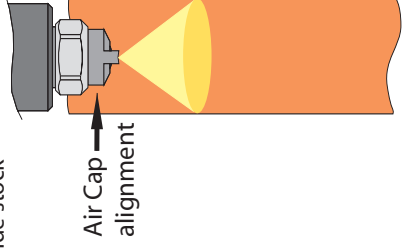

2

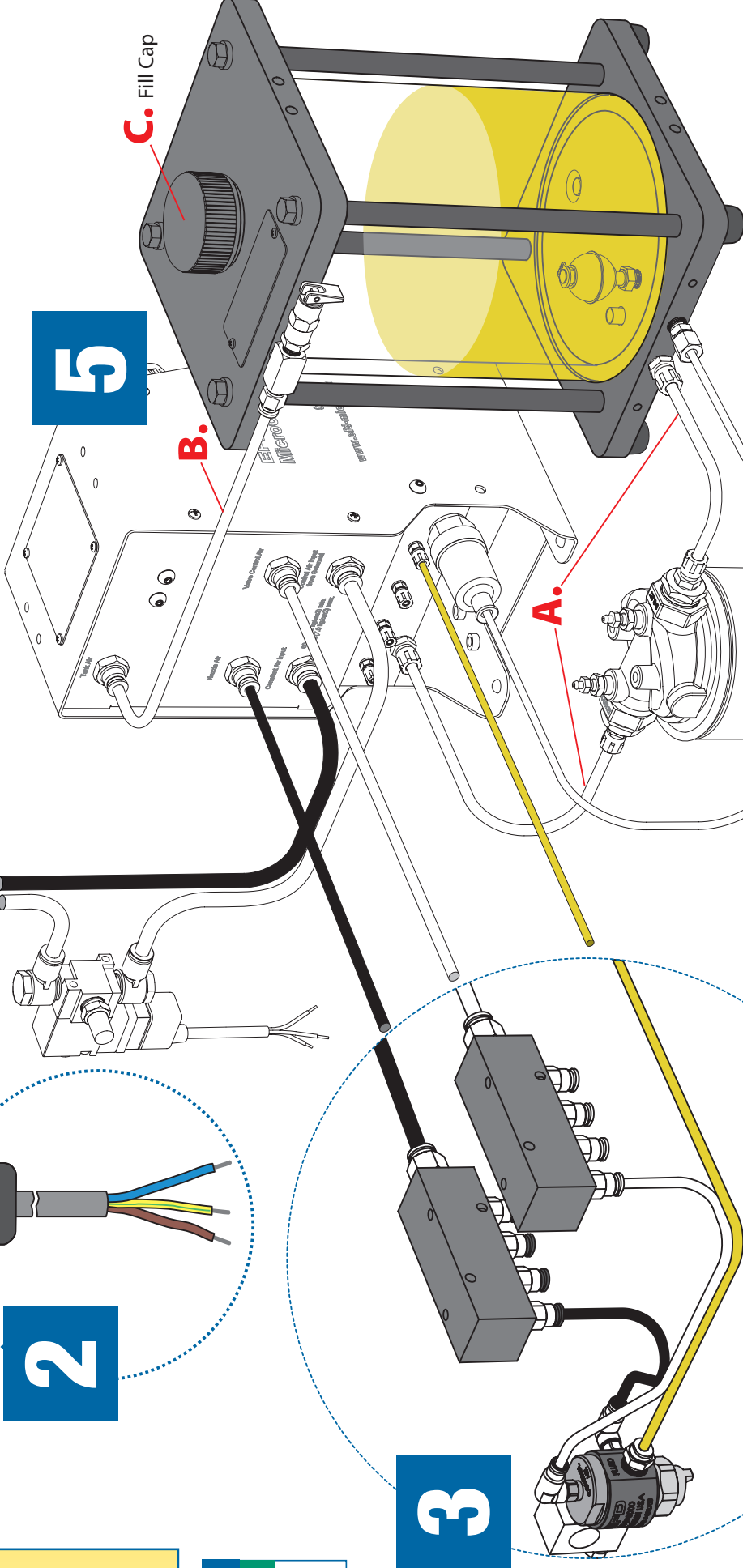

5

C. Fill Cap

KEY

- black hose to black Nozzle Air fitting
- white hose to white Valve Control Air fitting
- clear fluid hose to Fluid Outlet fitting

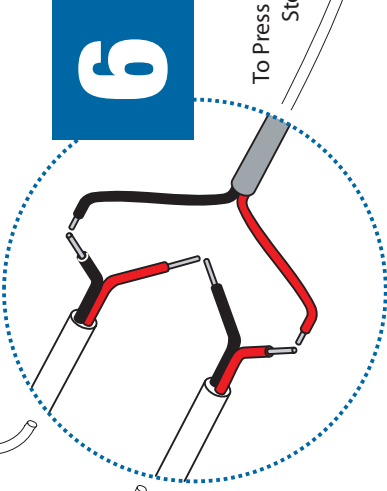

6

NOTE: Review steps 2 & 6 with plant electrician.

Fixturing

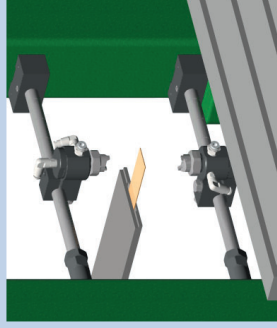

Expansion Mount Kit #MC7325

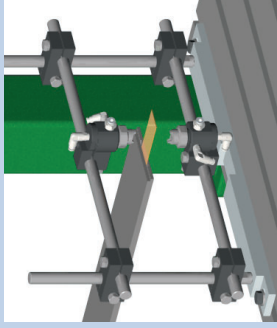

Gantry Style Mount Kit #MC7328

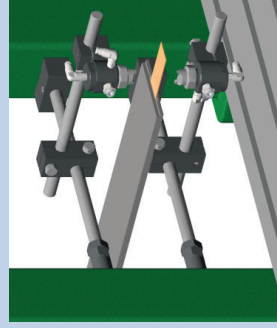

Extension rods (#7327) and cross clamps (#MC7321) are available. Contact EFD for details.