

The 725-HL dispense gun is a rugged industrial hand-operated fluid dispensing valve. The valve incorporates a quick change fluid body for fast and easy maintenance. Included with the valve are two fluid inlet fittings for 1/4" OD or 3/8" OD feed tubing and an assortment of dispensing tips.

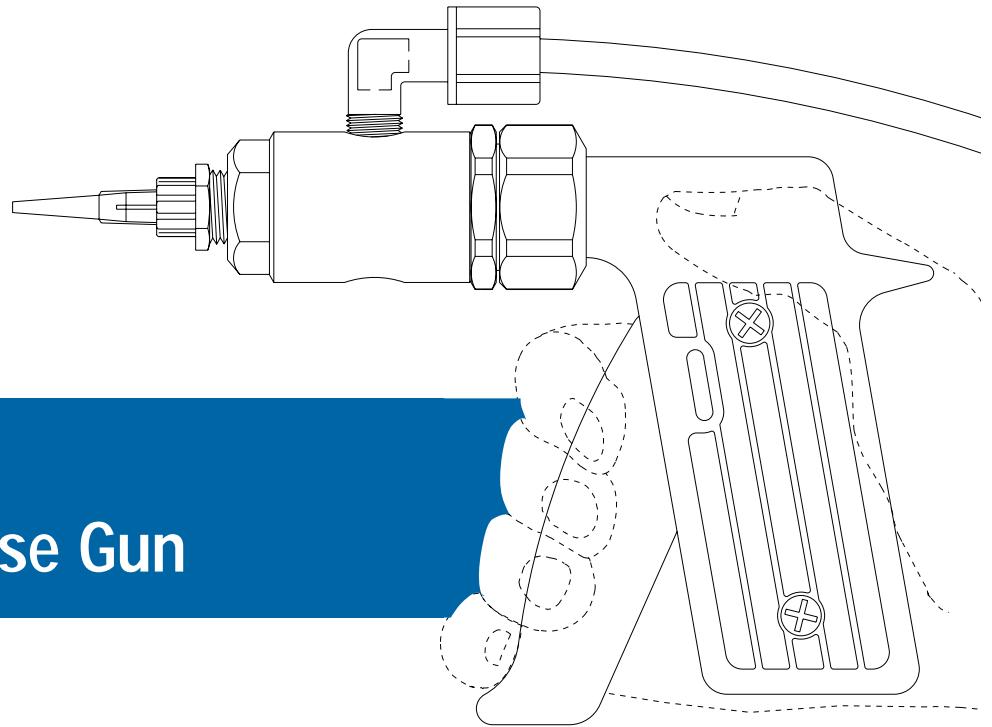

User's Guide 725-HL Dispense Gun



USA: 800-556-3484 or +1-401-434-1680
 Europe: 0800 585733 or +44 (0) 1582 666334
 Asia: +86 (21) 5854 2345
 technical@efd-inc.com www.efd-inc.com

Electronic pdf files of EFD® manuals are also available at www.efd-inc.com/manuals.html

Replacement Parts

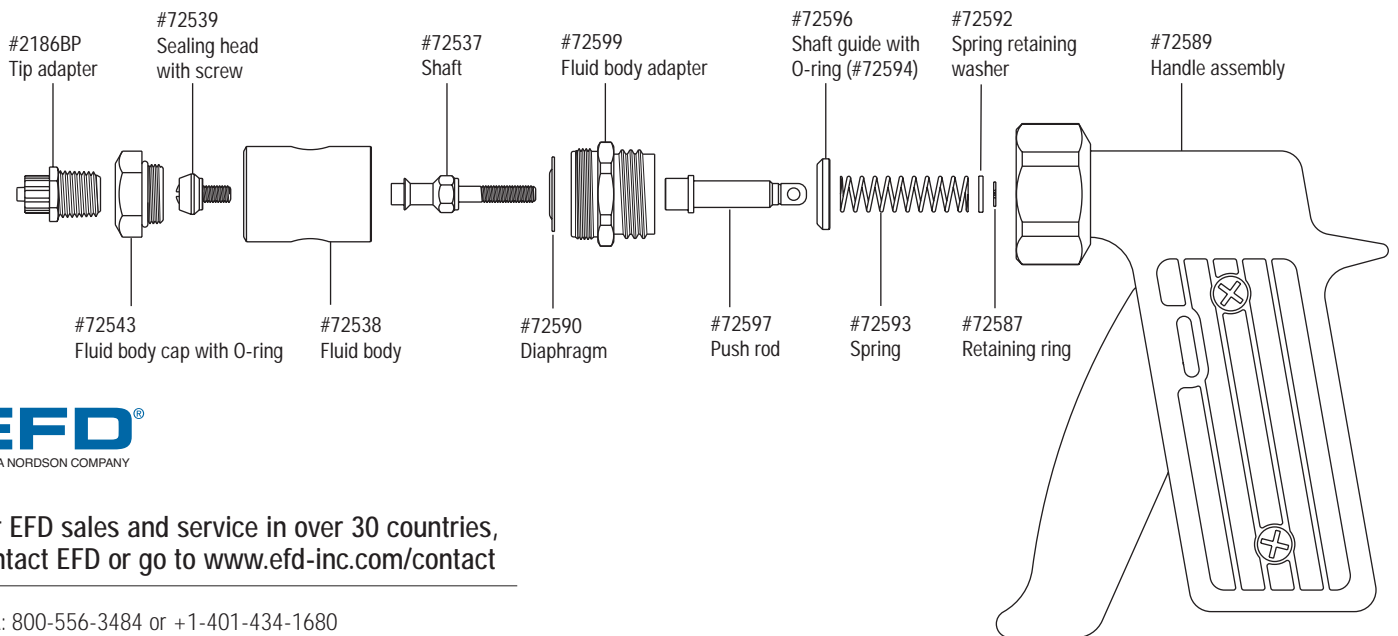

For EFD sales and service in over 30 countries, contact EFD or go to www.efd-inc.com/contact

USA: 800-556-3484 or +1-401-434-1680
 Europe: 0800 585733 or +44 (0) 1582 666334
 Asia: +86 (21) 5854 2345
 technical@efd-inc.com www.efd-inc.com/contact

Operation

1. Install the fluid fitting into the inlet port ❶. Use the 1/4" fitting for low to medium viscosity fluids and the 3/8" fitting for high viscosity fluids.
2. Install the appropriate size feed tube to the inlet fitting and tighten the compression nut to secure. The position of the inlet fitting can be adjusted. Loosen the fluid body retaining nut ❷, rotate the fluid body to the desired position and tighten the retaining nut.
3. Apply air pressure to the fluid reservoir. Start with a low setting of 20 psi (1.4 bar). If using an EFD fluid reservoir, refer to the User's Guide for further instructions.
4. Install an appropriate size dispensing tip to the outlet tip adapter ❸. Use large tips for high viscosity materials and small tips for low viscosity.
5. Pull the trigger to begin fluid flow. Release trigger to stop flow.
6. To achieve desired flow, change the size of the dispensing tip or adjust the reservoir fluid pressure.

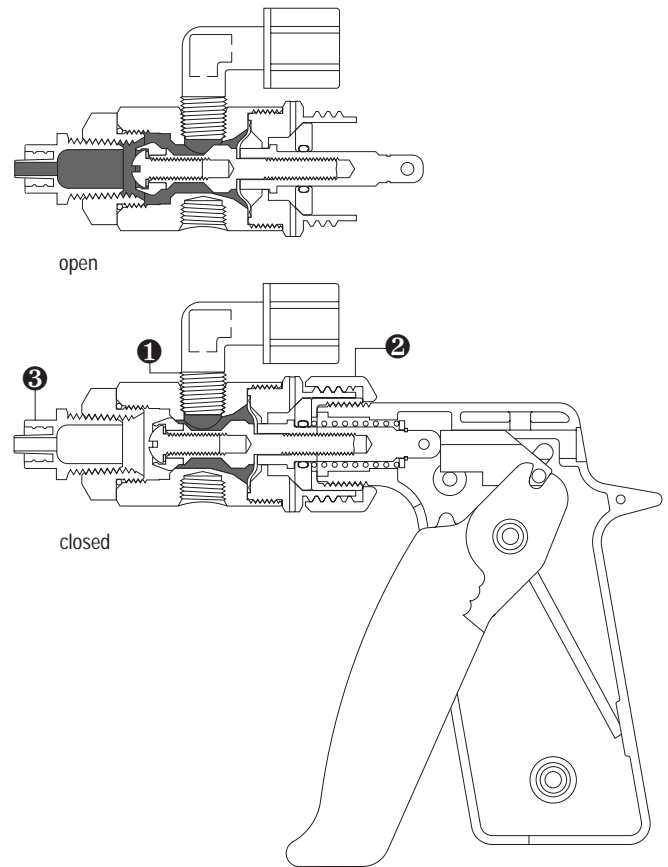

Service

Follow the exact sequence below to service the fluid body.

1. Loosen the retaining nut ❶ and remove the fluid body.
2. Insert maintenance rod ❷ and remove fluid body cap ❸.
3. Insert rod ❹ through push rod hole and remove sealing head ❺ with flat screwdriver. Remove rod ❹.
4. Hold rod ❷ and remove the fluid body adapter ❻ from the fluid body.
5. Insert and hold rod ❹ and remove shaft ❼ and diaphragm.
6. Clean fluid body components and replace sealing head and diaphragm if required.
7. Install diaphragm in direction shown in *Figure 1*. Hold rod ❹ and install shaft; tighten to 15 inch pounds.
8. Apply a film of lubricant to fluid body shoulder "A". Hold rod ❷ and reinstall adapter ❻. Tighten to 10 foot pounds.
9. Insert and hold rod ❹ and install sealing head; tighten to 15" pounds. Install fluid body cap ❸.
10. Install fluid body onto handle, align body to desired position and tighten retaining nut ❶.

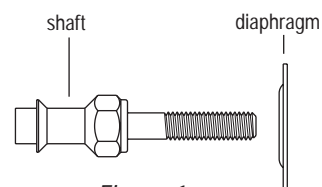
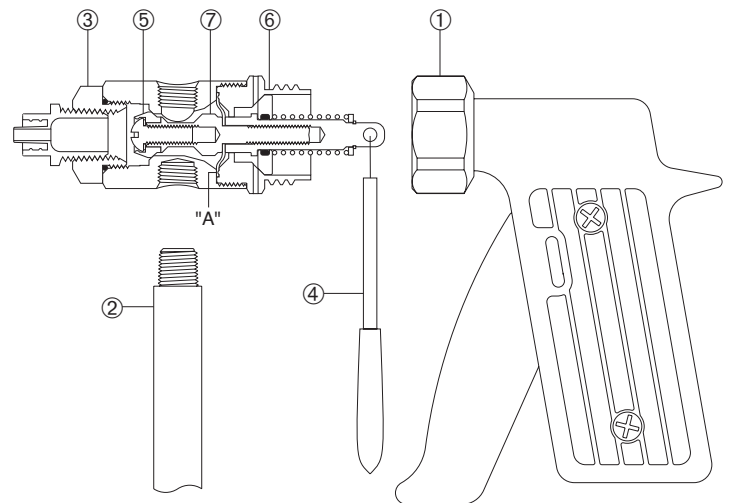

Figure 1

Maintenance Tools:

- 1/8" rod (part #7803)
- 1/8" NPT maintenance rod (part #72561)
- 10" adjustable wrench*
- flat screwdriver*
- *customer supplied